

STAINLESS STEEL ASTM A182, ASA 150lb Raised Face Slip On Flanges

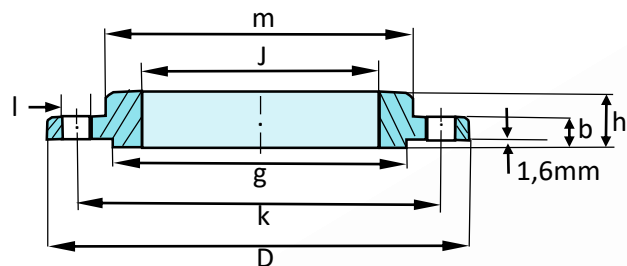

Pipe		Flange				Hub	Raised face	Drilling template		Weight	Stock standard		
Nom. size	O.D.1	D	J	b	h	m	g	l	k	No. of holes	kg/pce	ASTM 304L	ASTM 316L
in.	mm	mm	mm	mm	mm	mm	mm	mm	mm				
0.50in	21.3	88.9	22.4	11.2	15.7	30.2	35.1	15.7	60.5	4	0.39	●	●
0.75in	26.7	98.6	27.7	12.7	15.7	38.1	42.9	15.7	69.9	4	0.56	●	●
1.00in	33.4	108.0	34.5	14.2	17.5	49.3	50.8	15.7	79.2	4	0.78	●	●
1.25in	42.2	117.3	43.2	15.7	20.6	58.7	63.5	15.7	88.9	4	1.03	●	●
1.50in	48.3	127.0	49.5	17.5	22.4	65.0	73.2	15.7	98.6	4	1.32	●	●
2.00in	60.3	152.4	62.0	19.1	25.4	77.7	91.9	19.1	120.7	4	2.06	●	●
2.50in	73.0	177.8	74.7	22.4	28.4	90.4	104.6	19.1	139.7	4	3.28	●	●
3.00in	88.9	190.5	90.7	23.9	30.2	108.0	127.0	19.1	152.4	4	3.85	●	●
4.00in	114.3	228.6	116.1	23.9	33.3	134.9	157.2	19.1	190.5	8	5.30	●	●
5.00in	141.3	254.0	143.8	23.9	36.6	163.6	185.7	22.4	215.9	8	6.07	●	●
6.00in	168.3	279.4	170.7	25.4	39.6	192.0	215.9	22.4	241.3	8	7.45	●	●
8.00in	219.1	342.9	221.5	28.4	44.5	246.1	269.7	22.4	298.5	8	12.10	●	●
10.0in	273.0	406.4	276.4	30.2	49.3	304.8	323.9	25.4	362.0	12	16.50	●	●
12.0in	323.8	482.6	327.2	31.8	55.6	365.3	381.0	25.4	431.8	12	26.20	●	●
14.0in	355.6	533.4	359.2	34.9	57.1	400.0	412.7	28.6	476.2	12	36.0	●	●
16.0in	406.4	596.9	410.5	36.5	63.5	457.2	469.9	28.6	539.7	16	46.00	●	●
18.0in	457.2	635.0	461.8	39.6	58.3	505.0	533.4	31.8	577.9	16	48.90	●	●
20.0in	508.0	698.5	513.1	42.9	73.2	558.8	584.2	31.8	365.0	20	61.90	●	●
24.0in	609.6	812.8	616.0	47.8	82.6	698.2	692.2	35.1	749.3	20	86.90	●	●